

Installation Manual

Roller Blind R05/9

For your safety



- Ensure that no parts can fall on anyone below.
- The insect screen is not suitable for fall protection.
- Installation may only be carried out by qualified personnel.



General Information



- No changes, attachments or conversions may be made to the product.
- Check the parts to ensure that they are in good condition before mounting. Do not mount damaged parts.



Please read these assembly instructions carefully, as we are not responsible for errors caused by incorrect installation! Use only stainless steel screws for mounting.

Front Assembly



Cap
14 23 91



RK 3,5 x 13
15 03 35.13.TX

Recommended Tools



Spirit Level



Lube Spray

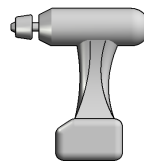

Power Drill

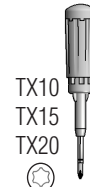

TX10
TX15
TX20
Screw Driver
and torx bits



HSS
Aluminum Drill
ø 2,5 mm
ø 4,0 mm
Countersink
ø 9,8 mm



Hole
Puncher

Horizontal Section

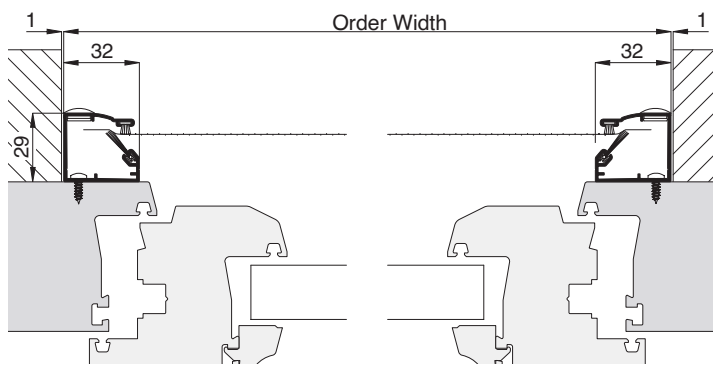

Vertical Section

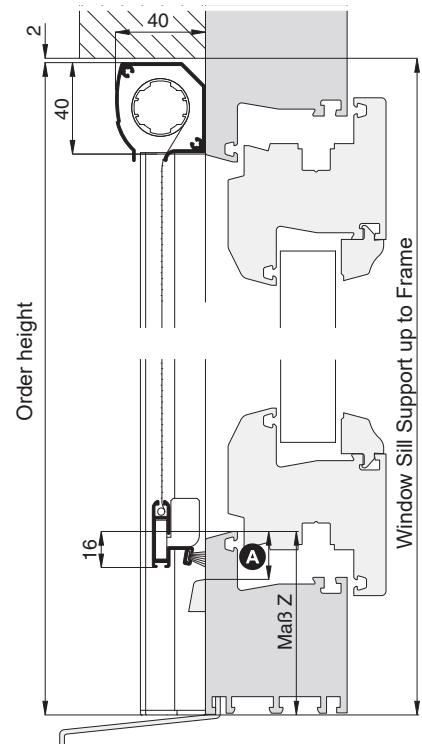

1 Guide Rails Mounting: Mounting Holes from the front

Mounting holes should be pre-drilled. If not, drill from front to back with a 4.0mm drill bit. (min 3 holes from a height of 1600mm). Use the countersink to open the front hole for the screw head. De-burr the holes from the back.

2 Assemble Flyscreen

⚠ The fabric must not be kinked at the weld seam!

Turn the roller blind box upside down. Operate and hold the roller lock, and put the guide rails on the left and right onto the pins of the box caps as far as they will go.

3 Install Flyscreen

Align the flyscreen at the installation site and transfer the installation holes. Pre-drill holes. In timber and plastic windows pre-drill with 2.5 mm drill bit. In aluminum windows pre-drill with drill Ø 3.1 mm. Align and screw on the flyscreen.

⚠ Ensure parallel alignment of the guide rails! Match lengths of the diagonals!

Test function of flyscreen. If required, change force of spring (see below). Replace caps.

⚠ Check the safe hold of the flyscreen!

Optional Settings

Change force of spring

Pull off guide rails, remove the screws on the right box cap (with the note "Feder") and hold the box cap in position.

⚠ Attention! Risk of injury! Box cap is under tension

Pull out box cap max. 70 mm while holding the box profile and box cap. The spring force can be increase by turning the box cap clockwise, and can be decreased by turning counter clockwise.

Push back the box cap and screw it back on. Put the guide rails and test the roller spring force. If necessary repeat the tensioning process.

Adjust the end position of the weight bar

The locking counterparts in the guide rails are preset at the factory. If necessary, the end position of the weight bar can be adapted on site. To do this, locate the locking counterpart behind the brush. Using an Allen key 2.0 mm, loosen the fixing screw. Move the locking counterpart vertically and retighten the fixing screw. Test the position of the weight bar. Repeat the process if necessary.